

NOTES:

Materials: BRASS per QQ-B-626 half hard
A484 and A582. Beryllium Copper per ASTM-B-196, QQ-C-530
PTFE Fluorocarbon per ASTM-D-1710

Finish: Center Conductors and solder components shall be plated per MIL-G-45204
Type II, Class 1 over Nickel plate per QQ-N-290.
Body and Body components shall be Nickel plated

Frequency: DC-18 GHz
VSWR: $1.05 + .005 \times \text{Frequency}$
Insertion Loss: $.05 \sqrt{\text{Frequency}}$

RECOMMENDED MATING TORQUE: 12 TO 15 IN.-LBS

41-160-1510-02

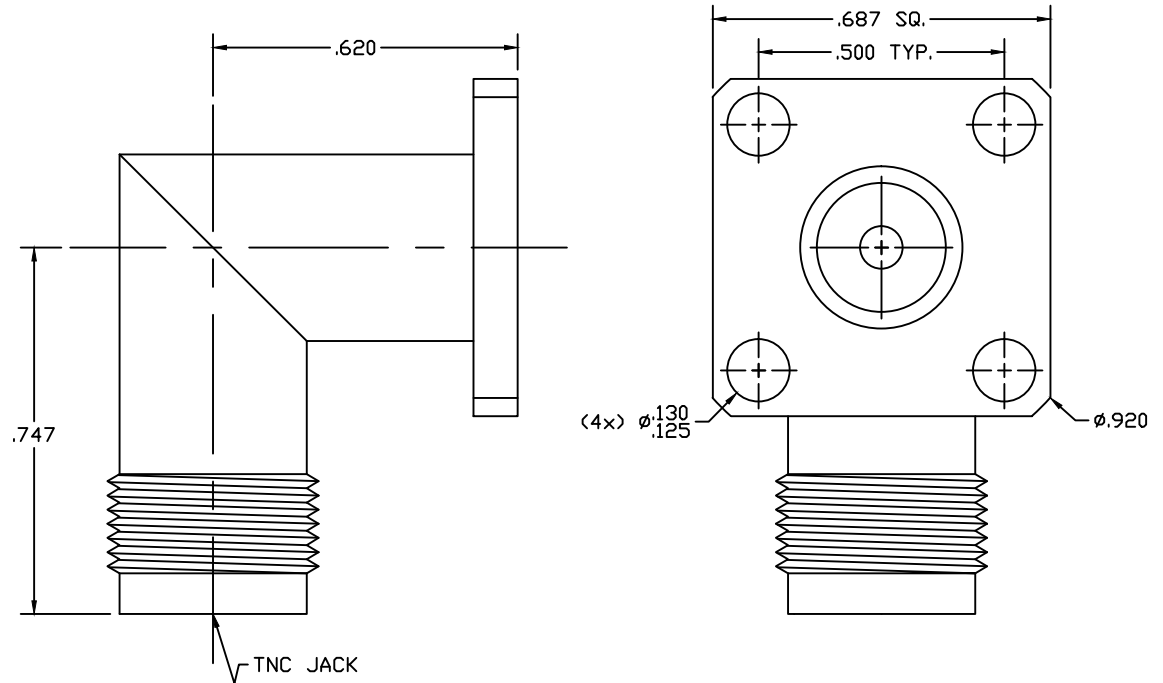

LTR	DESCRIPTION	DATE	APPR.	DRAWN LMW	CHECKED	USED ON	SRI CONNECTOR GAGE CO. 751 NORTH DRIVE MELBOURNE FL. 32934				
-	REL	02/03		APPR.	SCALE	41-160-1510-02					
				UNLESS OTHERWISE SPECIFIED: 1. REMOVE ALL BURRS 2. BREAK ALL CORNERS & EDGES .005 R. MAX 3. CHAMFER 1st & LAST THREADS 45° 4. SURFACE FINISHED 32√ UNLESS OTHERWISE SPECIFIED. 5. DIAMETERS ON COMMON CENTERS TO BE CONCENTRIC WITHIN .002 T.I.R. 6. ALL DIMENSIONS ARE AFTER PLATING.		MATERIAL	TITLE				
				DIMENSIONS ARE IN INCHES TOLERANCES		FINISH	TNC JACK (4) HOLE FLANGE				
				DECIMALS .X ±.030 .XX ±.010 .XXX +.005	FRACTIONAL ± 1/64	ANGULAR .X° ±1°0' .X'X' ±15'		SIZE	FSCM NO.	SHEET	DWG. NO.
								A	OHMO1	1	41-160-1510-02