

1. TRIM CABLE TO DIMENSIONS AS SHOWN.

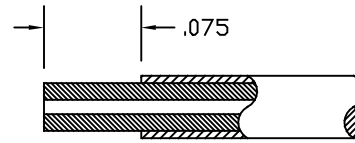

1. FORM A RING (360°) WITH .010 SOLDER RING AROUND CABLE.
2. USING RESISTIVE SOLDERING IRON, HEAT HOUSING (HOLDING DOWNWARDS) UNTIL SOLDER FLOWS EVENLY AROUND CABLE HOUSING.
3. TRIM DIELECTRIC FLUSH AS SHOWN IN FIGURE.
4. FILE END IF CABLE TO 60°. REMOVE BURRS AND SHARP EDGES FROM CENTER CONDUCTOR.

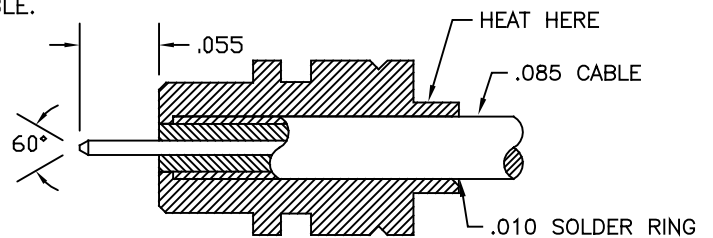

1. INSERT BODY INTO COUPLING NUT

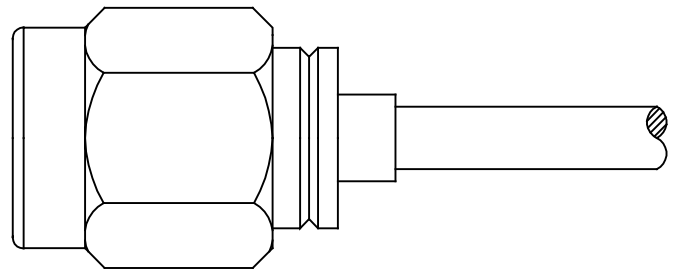

USED ON  
26-000-1085-01

 SRI CONNECTOR GAGE CO.  
751 NORTH DRIVE  
MELBOURNE FL. 32934

DIMENSIONS ARE IN INCHES TOLERANCES		
DECIMALS	FRACTIONAL	ANGULAR
.X ±.030	± 1/64	° ±1'0"
.XX ±.015		' ±15'
.XXX +.005		

TITLE  
ASSEMBLY INSTRUCTIONS  
2.4mm PLUG TO  
.085 SEMI-RIGID CABLE

DRAWN LMW DATE 03/02

SIZE A FSCM NO. OHM01

SHEET 1 USED ON 26-000-1085-01